

Evolution* Series E9000 Motor Control Center

Renewal Parts Bulletin

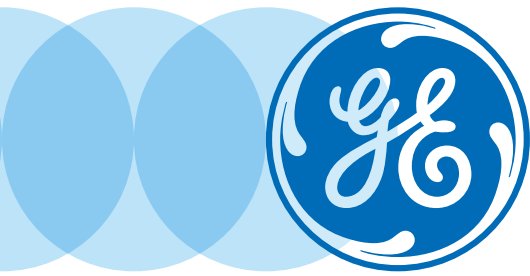

Table of Contents

Introduction

The E9000-Line motor control center, a quality product of the General Electric Company, has been designed and manufactured to give long and satisfactory service. This Renewal Parts Bulletin contains items which, through normal use, may require periodic maintenance and replacement. Other items may never need service or replacement during the useful life of the equipment.

We feel that you are in the best position to determine your investment in Renewal Parts, taking into consideration the total amount of E9000-Line motor control centers at your facility, your proximity to General Electric franchised distributors, and the importance of minimizing equipment downtime.

For identifying and ordering replacement parts not included in this publication, refer to the “Spares Recommendation” and “Parts List” section of the renewal parts quotation for your motor control center. If this is not available, identify the equipment as follows before contacting your local distributor or General Electric sales office:

1. Equipment GE Evolution Series E9000 motor control center.
2. Complete vertical section nameplate information (for structural and bus parts)
3. Complete plug-in unit nameplate information (for individual unit parts)

Introduction.....	2
Ordering Instructions.....	3
Structural Parts	4
Vertical & Main Bus Parts.....	6
Unit Parts.....	10
Handle/Handle Assembly	10
Fusible Disconnect Switch	11
Control Power Transformer	12
Terminal Boards	12
Overload Reset Assembly	13
Power Stab Harnesses.....	13
Miscellaneous.....	13
Torque Table.....	14

Ordering Instructions

The ordering of renewal parts or complete unit replacements will be simplified by referencing the data provided on the E9000 motor control center section nameplate and, if required, unit nameplate.

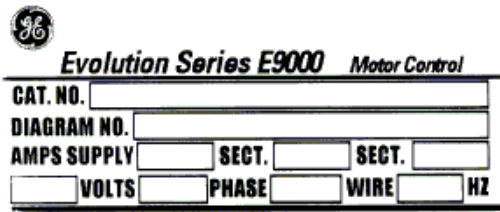

Evolution Series E9000 Motor Control

CAT. NO.

DIAGRAM NO.

AMPS SUPPLY SECT. SECT.

VOLTS PHASE WIRE HZ



MOTOR CONTROL CENTER
SECTION OF
NO. PLANT **ME**

BUS SHORT CIRCUIT RATING RMS
SYMMETRICAL AMPS 600 VOLTS MAXIMUM. DO NOT
INSTALL ON CIRCUITS WITH AVAILABLE SHORT-CIRCUIT
CURRENTS GREATER THAN THE LOWEST SHORT-CIRCUIT
RATING OF ANY INSTALLED UNIT.

NP204B4142EXP42 MEBANE N.C. MADE IN U.S.A.

Section Nameplate (located on the front of each UL listed section, near the upper right-hand corner):

†**CAT. NO.:** The General Electric, Mebane, N.C., factory catalog number

†**DIAGRAM NO.:** The outline summary sheet (often referred to as “record drawings”) for this section

AMPS-SUPPLY: The main (i.e. horizontal) bus rating

AMPS-SECTION: The vertical bus rating

When ordering replacement parts not identified in this bulletin, both the “CAT. NO.” and “DIAGRAM NO.” must be referenced, accompanied by a complete description of the replacement part(s) desired.

†**This information must be included in the order form.**

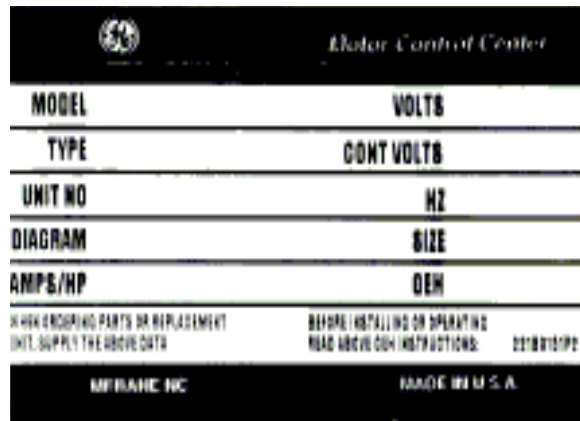

Motor Control Center

MODEL	VOLTS
TYPE	CONT VOLTS
UNIT NO	HZ
DIAGRAM	SIZE
AMPS/HP	GEN

WHEN ORDERING PARTS OR REPLACEMENT UNIT, SUPPLY THE ABOVE DATA

BEFORE INSTALLING OR OPERATING READ ABOVE CONSTRUCTION INSTRUCTIONS: 2210121011P

MEBANE, N.C. MADE IN U.S.A.

Unit Nameplate (plug-in units; located on the right-hand vertical side barrier; bolt-in units; located in close proximity to the branch circuit overcurrent protective device):

MODEL: Type of motor control center design

VOLTS TYPE: Unit power supply voltage unit function (as listed on outline summary sheet)

†**CONT. VOLTS UNIT NO.:** Unit control voltage. The factory catalog number; this identifies the section and unit location within that section.

DIAGRAM: The outline summary sheet and page number which contains the wiring elementary diagram for this unit

SIZE AMPS/HP: The NEMA size rating of the starter. The ampere rating of the circuit breaker or fusible switch (for feeder unit), or horsepower rating (for combination starter units).

When ordering a complete replacement unit or replacement parts not identified in this bulletin, the “MODEL”, “UNIT NO.”, and “DIAGRAM” must be referenced, accompanied by a complete description of the replacement part(s) desired.

Structural Parts

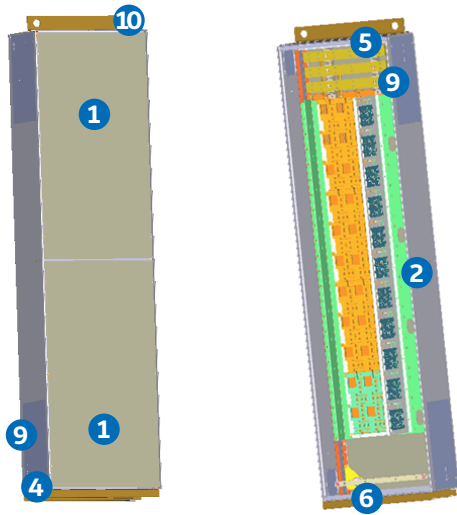

Item Number	Part Description	Page Number
1	Rear Cover	4
2	Side Case Assembly	4
3	Case Sill (See Figure 3)	4
4	Rodent Barrier	4
5	Front Top Cover Plate	4
6	Floor Plate	5
7	Mullions, Wireway (See Figure 7)	5
8	Full Width Mullions (See Figure 8)	5
9	Side Enclosure Cover	5
10	Lifting Angle	6

Item 1 - Rear Cover

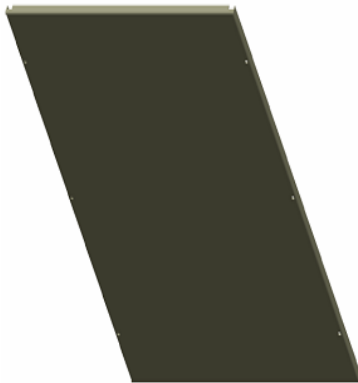

Figure 1

33 x 20	190B1007P1
33 x 24	190B1007P2
33 x 30	190B1007P3
33 x 36	190B1007P4
39 x 20	190B1007P5
39 x 24	190B1007P6
39 x 30	190B1007P7
39 x 36	190B1007P8
45 x 20	190B1007P9
45 x 24	190B1007P10
45 x 30	190B1007P11
45 x 36	190B1007P12
24 x 20	190B1007P13

Screw, Steel T-Roll 10-24 X 3/4 (6)

Item 2 - Side Case Assembly

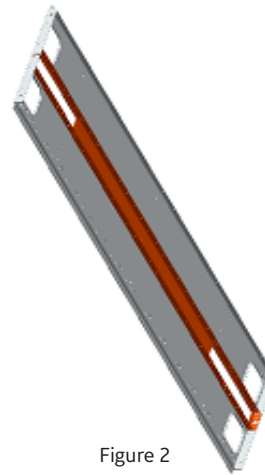

Figure 2

Enclosure side With Channel 90 x 20 x 3	201D1001G1
Enclosure side With Channel 90 x 22 x 5	201D1001G4
Enclosure side With Channel 90 x 30 x 5 Rear Aligned	201D1001G10
Enclosure side BTB With Channel 90 x 25 x 3	201D1034G1
Enclosure side BTB With Channel 90 x 25 x 5	201D1034G2

Item 3 - Case Sills



Figure 3

Case Sill 20 IN	190B1009P1
Case Sill 24 IN	190B1009P2

Item 4 - Rodent Barrier

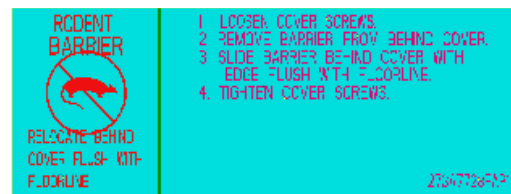

Figure 4

BARRIER, RODENT 13D 3IN	190B2177G1
BARRIER, RODENT 20D 3IN	190B2177G2
BARRIER, RODENT 22D 5IN	190B2177G3
BARRIER, RODENT 30D 3IN	190B2177G4

Screw, Steel T-Roll 1/4-20 X 3/8 (1)

Item 5 - Front Top Cover Plate



Figure 5

20 x 8	190B1060P1
24 x 8	190B1060P2

Screw, Steel T-Roll 1/4-20 X 3/8 (8)

Item 6 - Floor Plate

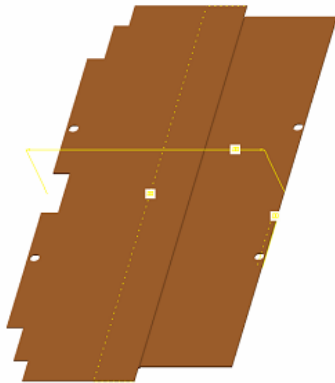

Figure 6A (Front)

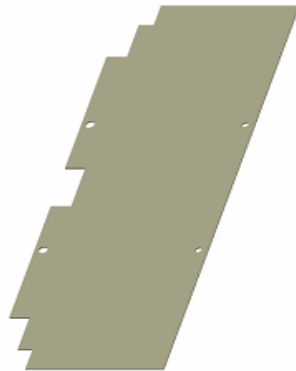

Figure 6B (Rear)

Front 20 x 20/30	110C1030P1
Front 20 x 22	110C1030P2
Front 24 x 20/30	110C1030P3
Front 24 x 22	110C1030P4
Front 20 x 25	110C1030P10
Front 24 x 25	110C1030P11
Rear 20 x 20	110C1060P1
Rear 20 x 22	110C1060P2
Rear 24 x 20	110C1060P4
Rear 24 x 22	110C1060P5
Rear 20 x 25	110C1060P1
Rear 24 x 25	110C1060P4

Screw, Steel T-Roll 1/4 -20 X 5/8 (4)

Item 7 - Mullions, Wireway (See also Page 6)

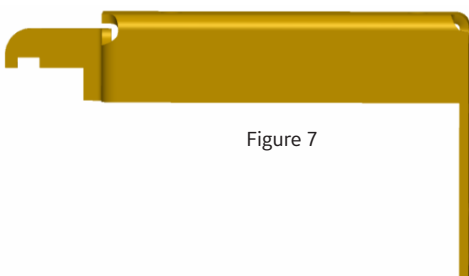

Figure 7

4 IN Case Width 20 IN	190B1255P1
9 IN Case Width 24 IN	190B1255P2
15 IN Case Width 30 IN	190B1255P3

Item 8 - Full Width Mullions



Figure 8

Top 20W	190B1238P1
Top 24W	190B1238P2
Top 30W	190B1238P3
Top 36W	190B1238P4

Item 9 - Side Covers



Figure 9

Cover, Side Enclosure 20/30 IN 3IN Vert	110C1029G1
Cover, Side Enclosure 22/30 IN 5IN Vert	110C1029G2
Cover, Side Enclosure 13 IN 3IN Vert	110C1029G3
Cover, Side Enclosure 25IN BTB	110C1029G11

Screw, Steel T-Roll 1/4-20 X 1/2 (4)

Item 10 - Lifting Angle



Figure 10

Angle, Lifting ASM 20	110C1044G1
Angle, Lifting ASM 20 x 20	110C1044G2
Angle, Lifting ASM 20 x 20 x 20	110C1044G5

Includes Bolting Hardware

Floor Sill



Floor Sill - 20"	110C1043G1
Floor Sill - 20" - 20"	110C1043G2
Floor Sill - 20" - 20" - 20"	110C1043G6

Vertical & Main Bus Parts

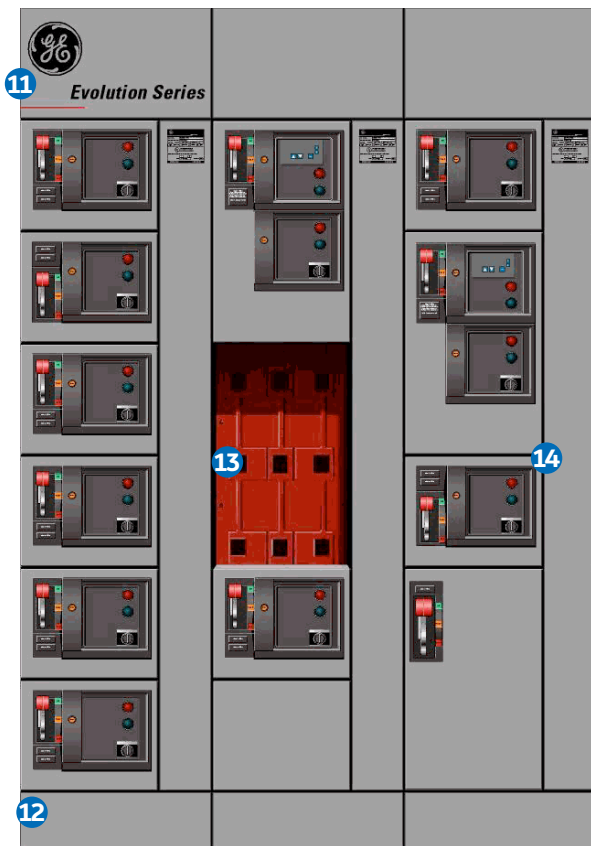

Item 11 - Top Wireway Door



Figure 11

DOOR, ASSEMBLY, TOP WIRE WAY, 20 X 12	110C1440G1
DOOR, ASSEMBLY, TOP WIRE WAY, 20 X 18	110C1440G2
DOOR, ASSEMBLY, TOP WIRE WAY, 24 X 12	110C1440G6
DOOR, ASSEMBLY, TOP WIRE WAY, 24 X 18	110C1440G7
DOOR, ASSEMBLY, TOP WIRE WAY, 30 X 12	110C1440G14
DOOR, ASSEMBLY, TOP WIRE WAY, 30 X 18	110C1440G15

Includes Door Hinges, Latch Assembly, Case Side Hinges, Door Pin, and Split Pin

Item 12 - Bottom Wireway Door

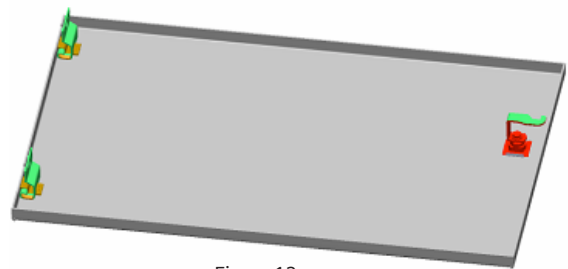

Figure 12

DOOR, ASSEMBLY, BOTTOM WIREWAY, 20 X 12	110C1450G1
DOOR, ASSEMBLY, BOTTOM WIREWAY, 20 X 18	110C1450G2
DOOR, ASSEMBLY, BOTTOM WIREWAY, 24 X 12	110C1450G6
DOOR, ASSEMBLY, BOTTOM WIREWAY, 24 X 18	110C1450G7
DOOR, ASSEMBLY, BOTTOM WIREWAY, 20 X 6	110C1450G11
DOOR, ASSEMBLY, BOTTOM WIREWAY, 24 X 6	110C1450G12
DOOR, ASSEMBLY, BOTTOM WIREWAY, 30 X 12	110C1450G16
DOOR, ASSEMBLY, BOTTOM WIREWAY, 30 X 6	110C1450G54
DOOR, ASSEMBLY, BOTTOM WIREWAY, 30 X 18	110C1450G59

Includes Door Hinges, Latch Assembly, Case Side Hinges, Door Pin, and Split Pin

Item 13 - Vertical Bus Accessories



Figure 13A

Stab Opening Cover	190B1215P1
--------------------	------------



Figure 13B

Bottom Vertical Bus Barrier	190B1549G1
-----------------------------	------------

Item Number	Part Description	Page Number
11	Top Wireway Door	7
12	Bottom Wireway Door	7
13	Vertical Bus Accessories	7
14	Vertical Wire Way Door Assembly	8



Reference

Item Number	Part Description	Page Number
15	Ladder Assembly	8
16	Ladder Assembly Cut Out	8
17	Shelf Assembly	9
18	Blank Unit Door Assembly (See Figure 18)	9
19	Filler Kits (Not Shown)	10

Item 13 - Vertical Bus Accessories (continued)

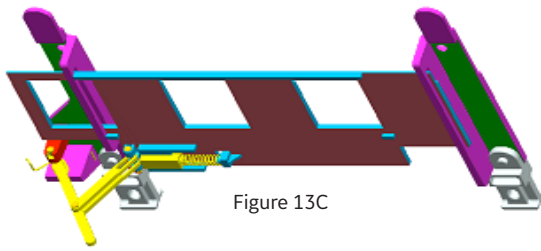

Figure 13C

Vertical Bus Shutter ASM At Top Most	110C1783G1
Vertical Bus Shutter ASM At Middle	110C1783G2
Vertical Bus Shutter ASM At Bottom Most	110C1783G3

Gasket	3245A1888P7
--------	-------------

(.13" x 1/2") 25' Roll, Closed Cellular black neoprene, UL recognized (JMST2) with pressure sensitive adhesive and removable backing.

N3R Door Filter	75C143964P102
-----------------	---------------

Aluminum Framed Uni-Foam Media 4.75" x 17.5" (Qty-2 per door)

Item 14 - Vertical Wireway Door Assembly

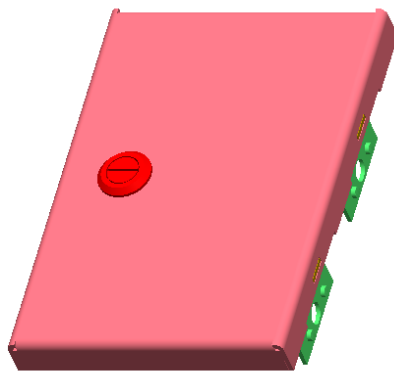

Figure 14

20" Wide Section	
5W 6H	110C1163G1
5W 12H	110C1163G2
5W 18H	110C1163G3
5W 24H	110C1163G4
5W 30H	110C1163G5
5W 36H	110C1163G6
5W 42H	110C1163G7
5W 48H	110C1163G8
5W 54H	110C1163G9
5W 60H	110C1163G10
5W 66H	110C1163G11
5W 72H	110C1163G12

Item 14 - Vertical Wireway Door Assembly (continued)

24" Wide Section	
9W 6H	110C1163G13
9W 12H	110C1163G14
9W 18H	110C1163G15
9W 24H	110C1163G16
9W 30H	110C1163G17
9W 36H	110C1163G18
9W 42H	110C1163G19
9W 48H	110C1163G20
9W 54H	110C1163G21
9W 60H	110C1163G22
9W 66H	110C1163G23
9W 72H	110C1163G24

Item 15 - Ladder Assembly

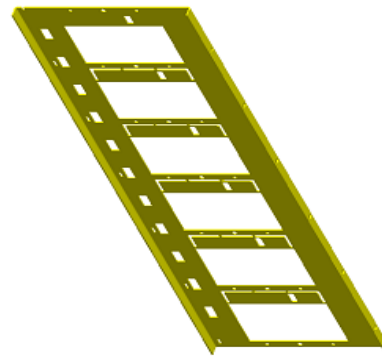

Figure 15

36 IN	110C1010P1
30 IN	110C1010P2
24 IN	110C1010P3
18 IN	110C1010P4
12 IN	110C1010P5
42 IN	110C1010P6
48 IN	110C1010P7
54 IN	110C1010P8
60 IN	110C1010P9
66 IN	110C1010P10
72 IN	110C1010P11
6 IN	110C1010P12

Item 16 - Wireway Knockout Plate

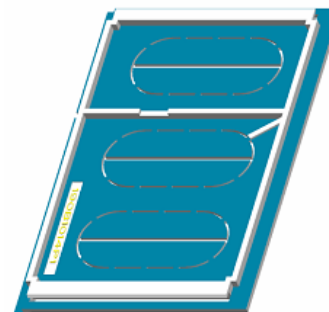

Figure 16

Wireway knockout plate	190B1014P1
------------------------	------------

1 used every 6"

Item 17 - Shelf Assembly

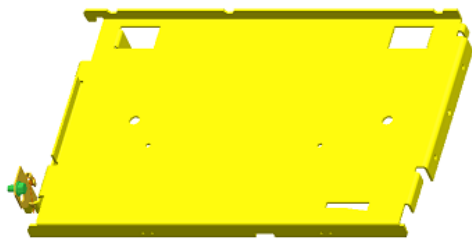

Figure 17

Shelf and Bracket Assembly	110C1850P1
----------------------------	------------

Item 18 - Blank Unit Door Assembly



Figure 18

15 x 6	110C1240KKG1
15 x 12	110C1240KKG2
15 x 18	110C1240KKG3
15 x 24	110C1240KKG4
15 x 30	110C1240KKG5
15 x 36	110C1240KKG6
15 x 42	110C1240KKG7
15 x 48	110C1240KKG8
20 x 6	110C1240KKG9
20 x 12	110C1240KKG10
20 x 18	110C1240KKG11
20 x 24	110C1240KKG12
20 x 30	110C1240KKG13
20 x 36	110C1240KKG14
20 x 42	110C1240KKG15
20 x 48	110C1240KKG16
20 x 54	110C1240KKG17
20 x 60	110C1240KKG18
20 x 66 FOR 90 CASE HEIGHT	110C1240KKG19
20 x 72	110C1240KKG20
24 x 6	110C1240KKG21
24 x 12	110C1240KKG22
24 x 18	110C1240KKG23
24 x 24	110C1240KKG24
24 x 30	110C1240KKG25
24 x 36	110C1240KKG26
24 x 42	110C1240KKG27
24 x 48	110C1240KKG28
24 x 54	110C1240KKG29
24 x 60	110C1240KKG30
24 x 66 FOR 90 CASE HEIGHT	110C1240KKG31
24 x 72	110C1240KKG32
30 x 6	110C1240KKG33
30 x 12	110C1240KKG34
30 x 18	110C1240KKG35
30 x 24	110C1240KKG36
30 x 30	110C1240KKG37
30 x 36	110C1240KKG38

Item 18 - Blank Unit Door Assembly (continued)

30 x 42	110C1240KKG39
30 x 48	110C1240KKG40
30 x 54	110C1240KKG41
30 x 60	110C1240KKG42
30 x 66 FOR 90 CASE HEIGHT	110C1240KKG43
30 x 72	110C1240KKG44
36 x 60	110C1240KKG45
36 x 66 FOR 90 CASE HEIGHT	110C1240KKG46
20 x 90	110C1240KKG47
24 x 90	110C1240KKG48
20 x 24 (PULL BOX)	110C1240KKG49
20 x 30 (PULL BOX)	110C1240KKG50
24 x 24 (PULL BOX)	110C1240KKG51
24 x 30 (PULL BOX)	110C1240KKG52
15 x 54	110C1240KKG53
15 x 60	110C1240KKG54
15 x 66	110C1240KKG55
15 x 72	110C1240KKG56

Includes Door Hinges, Latch Assembly, Case Side Hinges, Door Pins, Nameplate, and Canoe Clips

Item 19 - Filler Kits

Description	Catalog Number
6" Filler kit	EK06
12" Filler kit	EK12

Common Doors



Door - Sz 1 - 6"	110C1540BAG1
Door - Sz 1 & 2 w/ P/B cutout - 12"	110C1540AAG11
Door - Sz 3 w/ P/B cutout - 18"	110C1540AAG12
Door - Sz 4 w/ P/B cutout - 24"	110C1540AZG13
Door - Sz 4 w/ P/B cutout - 30"	110C1540AZG14
Door - Sz 4 w/ P/B cutout - 36"	110C1540AZG15

Door - Sz 1 & 2 w/o P/B cutout - 12"	110C1540AAG1
Door - Sz 3 w/o P/B cutout - 18"	110C1540ABG2
Door - Sz 4 w/o P/B cutout - 24"	110C1540AZG3
Door - Sz 4 w/o P/B cutout - 30"	110C1540AZG4
Door - Sz 4 w/o P/B cutout - 36"	110C1540AZG5

6" Feeder Door	110C1540DAG2
12" Feeder Door	110C1540AAG41

Door Hinge

Cabinet Side Hinge	190B1013P1
Hinge Pin	190B1080P1

Main Bus Structural Parts



Item 20 - Clear Horizontal Bus Barriers



Figure 20

2" HORZ MAIN BUS BARRIER ASM, 20	110C1147G1
2" HORZ MAIN BUS BARRIER ASM, 24	110C1147G2
2" HORZ MAIN BUS BARRIER ASM, 30	110C1147G3
2" HORZ MAIN BUS BARRIER ASM, 36	110C1147G4

Main Bus Support



Main Bus Support - 2" Bus	190B1059P1
---------------------------	------------

Space Heater Assembly



Space Htr Asm - 12" Bottom - 20"	190B2643G1
Space Htr Asm - 12" Bottom - 24"	190B2643G2
Space Htr Asm - 12" Bottom - 30"	190B2643G3
Space Htr Asm - 6" Bottom - 20"	190B2643G9
Space Htr Asm - 6" Bottom - 24"	190B2643G10
Space Htr Asm - 6" Bottom - 30"	190B2643G11

Thermostat Assembly



Thermostat Assembly	190B2375G1
---------------------	------------

Cable Support



Cable Support	204B4135P1
---------------	------------

Main Bus Splice Kit

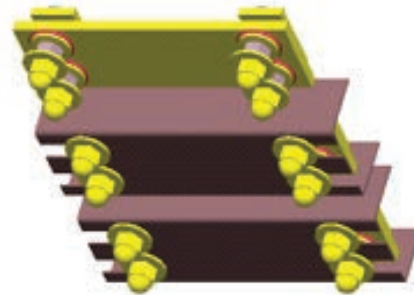

E9000 to E9000	Splice Kit - 3 phase
600A - 2" - Tin plated	110C1735G1SM
600A - 2" - Silver plated	110C1735G1KT
800A - 2" - Tin plated	110C1735G4SM
800A - 2" - Silver plated	110C1735G4KT
1000/1200A - 2" - Tin plated	110C1735G7SM
1000/1200A - 2" - Silver plated	110C1735G7KT
1600A - 4" - Tin plated	110C1735G10SM
1600A - 4" - Silver plated	110C1735G10KT
2500A - 2" - Tin Plated	110C1735G13SM
2500A - 2" - Silver Plated	110C1735G13KT
600A - 2" - Tin plated - for NEMA 3	110C1735G14SM
600A - 2" - Silver plated - for NEMA 3	110C1735G14KT
800A - 2" - Tin plated - for NEMA 3	110C1735G15SM
800A - 2" - Silver plated - for NEMA 3	110C1735G15KT
1000/1200A - 2" - Tin plated - for NEMA 3	110C1735G16SM
1000/1200A - 2" - Silver plated - for NEMA 3	110C1735G16KT

Unit Parts

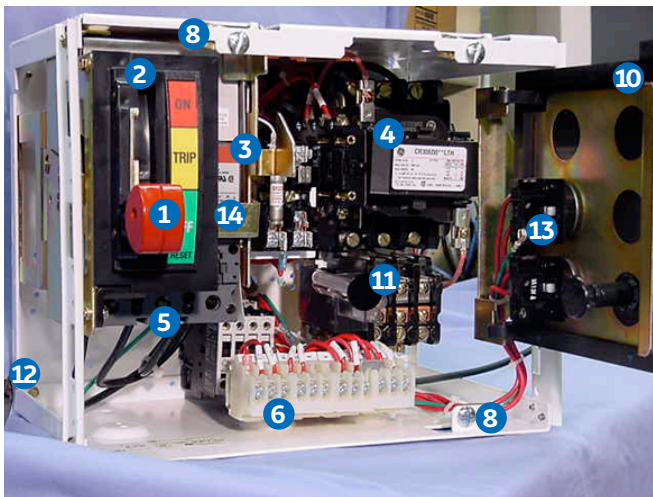

Item 1 - Handles for combination starter units, "Handle (Only)" includes plastic handle with egg shaped knob; "Handle assembly" includes handle, egg shaped knob, escutcheon, and steel linkage to mount on unit.

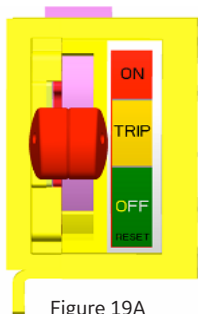

Figure 19A
190B1704G1 & G5

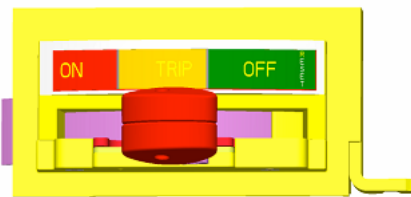

Figure 19B
190B1704G2

Handle Assemblies	Catalog Number
Escutcheon ASM, SZ1-4, SE, SF	190B1704G1
Escutcheon ASM, SZ1-4, 1/2 XSE	190B1704G2
Escutcheon ASM, 30/60/100 A QMW	190B1704G5

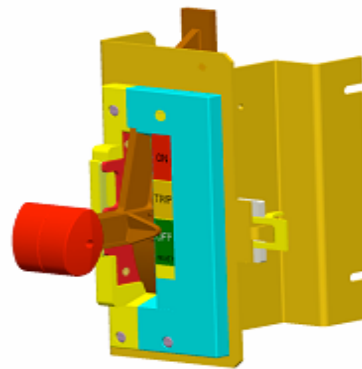

Figure 19C
G-Frame Assembly

Handle Assemblies	Catalog Number
G-Frame Handle Assembly - Sz 5 Starter	110C1130G1
QMW, 200A Handle Assembly	110C1130G2

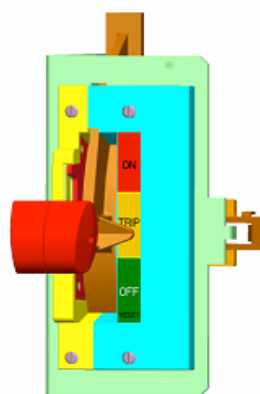

Figure 19D
110C1725G1

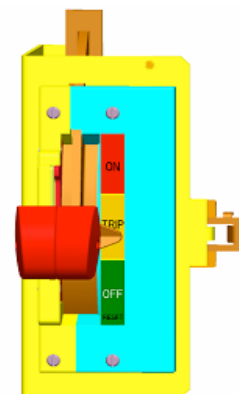

Figure 19E
110C1734G1

Handle Assemblies	Catalog Number
K-Frame Handle Assembly - Sz 6 Starter	110C1725G1
K-Frame Handle Assembly - Feeder / Main	110C1734G1

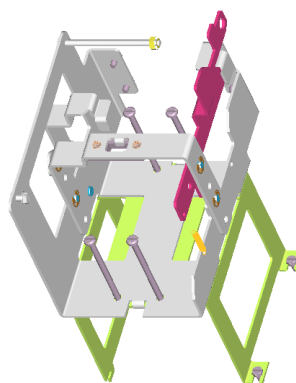

Figure 20
Handle Actuator Assembly

Item 2 - Handle Actuator Assembly includes metal actuator, top hat, and door defeater as shown below.

Handle Actuator Assembly	Catalog Number
SE-BREAKER OPERATOR SUB-ASM	110C1032G1
E-BREAKER OPERATOR SUB-ASM	110C1032G2
1/2X SE-BREAKER STARTER/FEEDER SUB-ASM	110C1032G3
1/2X E-BREAKER STARTER/FEEDER SUB-ASM	110C1032G4
DUAL FEEDER SUB-ASM	110C1032G5
DUAL FEEDER SUB-ASM WITH LOCK PROVISION	110C1032G6
F-FRAME ACTUATOR	110C1034G1

Item 3 - Branch Over-current Protective Device

Circuit Breaker: E9000-Line motor control centers utilize General Electric circuit breakers in combination starters, feeder tap units, and main disconnect units. Replacement circuit breakers may be purchased through General Electric Mebane, NC 27302. Order by the catalog number as it appears on the devices itself.

Fusible Disconnect: Modified versions of QMR and QMW switches are utilized in E9000-Line construction. When selecting the proper replacement switch, consideration must be given to the following:

1. Type of switch (QMR or QMW);
2. Size of starter, feeder tap, or main;
3. Fuse amperage and type of clip;
4. Power supply voltage

Complete fusible disconnect switches consists of switch assembly, fuse clip base or base (as required), plus other factory modifications. Order by complete catalog number as listed in the tables on the following pages.

Does Not Include Fuses

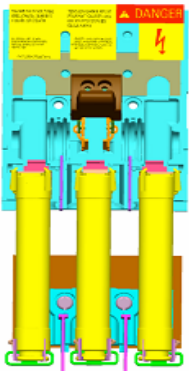

Figure 21A
110C1718G9M



Figure 21B
110C1719G5M

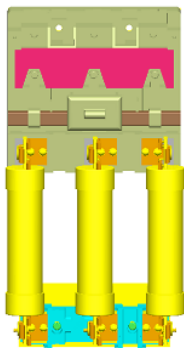
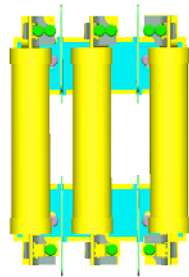

Figure 21C
110C1720G9M

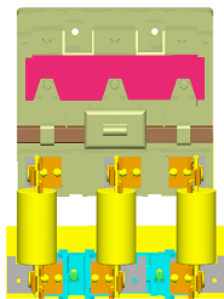

Figure 21D
110C1720G10M

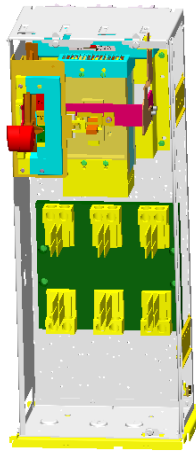

Figure 21E
110C1040GVG14

Item 3 - Fusible Disconnect Switches for Starter Units
(All functions except part winding.)

NEMA Size	Reference Figure	Switch Rating (Amperes)	Fuse Clips		QMW Switch Catalog Number
			Type	Rating (Amperes)	
1	21A	30	R	0-30	110C1718G9M
	21A		J	0-30	110C1718G1M
2	21A	60	R	31-60	110C1718G11M
	21A		J	31-60	110C1718G4M
3*	21B	100	R	61-100	110C1719G5M
	21B		R (Bottom Mount)	61-100	110C1719G13M
	21B		J	61-100	110C1719G1M
4	21B	200	J (Bottom Mount)	61-100	110C1719G9M
	21C		R	101-200	110C1720G7M
	21D	J	101-200	110C1720G2M	

* For 24 inch high unit, refer to Spare Recommendations before ordering.

Item 3 - Fusible Disconnect Switches for Feeder Units.

Switch Size (Amperes)	Reference Figure	Unit Door Height (inches)	Fuse Clips		QMW Switch Catalog Number
			Type	Rating (Amperes)	
30	21A	12	R	0-30	110C1718G13M
	21A		J	0-30	110C1718G1M
60	21A	12	R	31-60	110C1718G15M
	21A		J	31-60	110C1718G4M
100	21B	12	R	61-100	110C1719G5M
	21B		R (Bottom Mount)	61-100	110C1719G13M
	21B		J	61-100	110C1719G1M
20	21B	24	J (Bottom Mount)	61-100	110C1719G9M
	21C		R	101-200	110C1720G9M
	21D	J	101-200	110C1720G10M	

Item 3 - Fusible Disconnect Switches for Part Winding Starter Units Only (See Notes below)

NEMA Size	Reference Figure	Switch Rating (Amperes)	Fuse Clips		QMW Switch Catalog Number
			Type	Rating (Amperes)	
1	21A	30	R	0-30	110C1718G9M
	21A		J	0-30	110C1718G1M
1 or 2	21A	60	R	31-60	110C1718G11M
	21A		J	31-60	110C1718G4M
3	21B	100	R	61-100	110C1719G5M
	21B		J	61-100	110C1719G1M
3 or 4	21C	200	R	101-200	110C1720G7M
	21D		J	101-200	110C1720G2M

Item 3 - Fusible Disconnect Switches for Main Switches
(See Notes below)

Switch Size (Amperes)	Reference Figure	Unit Door Height (inches)	Fuse Clips		QMW Switch Catalog Number
			Type	Rating (Amperes)	
200	21C	30	R	101-200	110C1720G9M
	21D		J	101-200	110C1720G10M

Notes: For Item 3 (Fusible Disconnect Switch)

1. All switches listed are rated for 600 volts; for 250 volt applications, refer to Spare Recommendations.

Item 4 - Starter/Contactor - Refer to Spare Recommendations and Parts List for your motor control center. If none is available, refer to catalog number as it appears on the device itself before ordering replacement parts.

Item 5 - Control Power Transformer - (120 Volt Secondary 60 Hz)

Control Power Transformer	480 Volt Primary Catalog Number	600 Volt Primary Catalog Number
Size 1 FVNR/FVR (Standard) 60 VA	30213600YDP1	30213600YDP25
Size 2 FVNR/FVR (Standard) 150 VA	30213600YDP300	30213600YDP301
Size 3 FVNR/FVR (Standard) 300 VA	30213600YDP7	30213600YDP30
Size 4 FVNR/FVR (Standard) 300VA	30213600YDP7	30213600YDP30
1/2X Sz 1 Micron Transformer	MIC#B100-2989-5	-

Item 6 - Terminal Boards

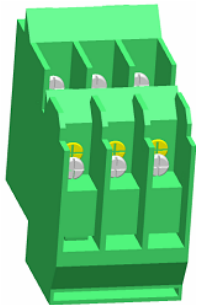

Figure 22A
190B1692G1

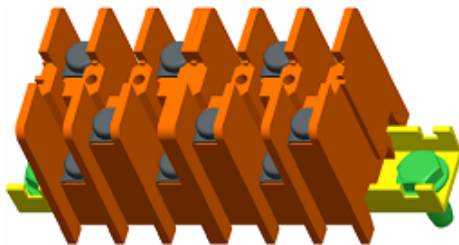

Figure 22B
190B1631G1

Control Terminal Boards

Pullapart	HD 3PT	190B1692G1
Stationary	Single 3 point T/B	190B1627P1
Stationary	HD 6PT	190B1631G1
Stationary	HD 12PT	190B1631G2
Stationary	HD 18PT	190B1631G3

Item 6A - Power Terminal Block

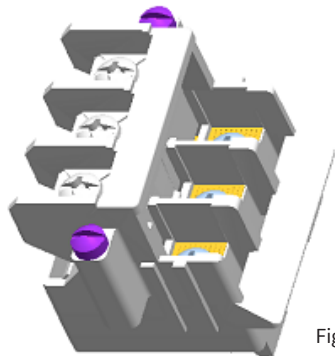

Figure 22C

Power Terminal Boards

Catalog Number	190B1691G1
----------------	------------

Item 7 - Door Latch Assembly (1/4 turn)



Figure 23

Catalog Number	190B1511P1
----------------	------------

Item 8 - Unit Frame Latch Assembly (1/4 turn)



Figure 24

Catalog Number	110C1572G1
----------------	------------

Item 9 - WireTrough Door Latch Assembly (1/4-turn)



Figure 25

Catalog Number	190B1512P1
----------------	------------

Item 10 - Pilot Device Bracket Escutcheon

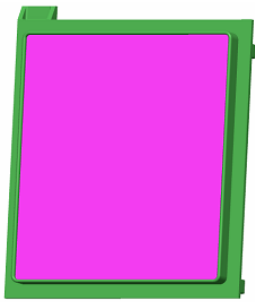

Figure 26A Blank

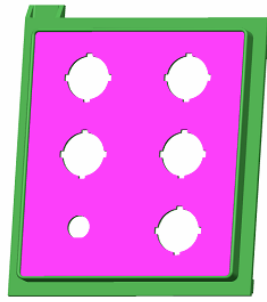

Figure 26B 6-Hole

Pilot Device	Catalog Number
Blank (No Holes)	110C1039P100
6 hole	110C1039P1
Plug Button Assembly (Black)	272A5650UWG2 (Not Pictured)
Plug Button Assembly (Gray)	272A5650UWG4 (Not Pictured)
Mounting Bracket	190B1512P1 (Not Pictured)

Item 11 - Overload Reset Assembly



Figure 27A
190B1048G1

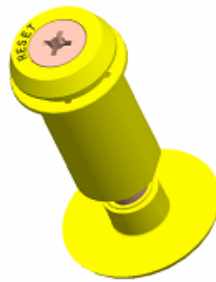

Figure 27B
190B1048G2

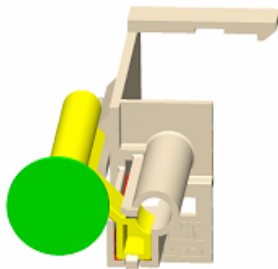

Figure 27C
190B1421G1

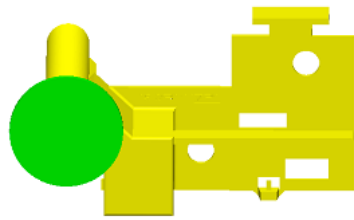

Figure 27D
190B1418G1

Door Mounted Reset	
Reset Button Assembly Bimetal Sz 1, 3, & 4	190B1048G1
Reset Button Assembly Bimetal Sz 2 & 5	190B1048G2
Reset Button Assembly Electronic Sz 1	190B1048G1
Reset Button Assembly Electronic Sz 2, 3, 4, & 5	190B1048G2
Clear Plastic OL Adapter	
OLR Reset Button Adapter Bimetal Sz 1, 2, & 5	190B1421G1
OLR Reset Button Adapter Bimetal Sz 3 & 4	190B1421G2
OLR Reset Button Adapter Electronic Sz 1 thru 5	190B1418G1

Item 12 - Vertical Ground Bus Stab Finger

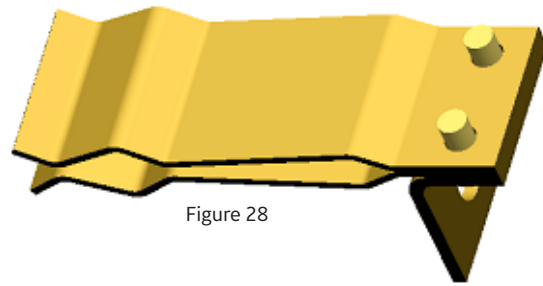

Figure 28

Catalog Number	270A1032G1
----------------	------------

Item 13 - Pilot Device (Type CR104P)

Refer to Spare Recommendations furnished with your motor control center.

Type CR104P Standard

Type C2000 for 1/2X starters

Item 14 - Fuse Block

1-Pole In Line	CSC#FEC-11-11
1-Pole Midget	CSC#30311
1-Pole CC	CSC#30311R
2-Pole Class CC	CSC#30312R
3-Pole Class CC	CSC#30313R
1-Pole CC Pull Out Din Rail Mtg	CSC#23302-G
2-Pole CC Pull Out Din Rail Mtg	CSC#23312-G
3-Pole CC Pull Out Din Rail Mtg	CSC#23314-G

**Item 18 - Stab Power Harness (includes harness and stab fingers)
Combination Starter Units:**

Function	NEMA Size	Catalog Number (For Circuit Breaker)	
		Tin	Silver
FVNR, FVR, and 2S1W or 2S2W	1	E9000L8G2	E9000L8G4
	2	E9000L8G2	E9000L8G4
	3	E9000L4G2	E9000L4G8
	4	E9000L4G15	E9000L4G16
	4 (F-Frame)	E9000L4G10	E9000L4G4

Function	NEMA Size	Amperes	Catalog Number (For Fusible Disconnect)	
			Tin	Silver
FVNR, FVR, and 2S1W or 2S2W	1	30	E9000L8G7	E9000L8G8
	2	60	E9000L8G7	E9000L8G8
	3	100	E9000L4G17	E9000L4G18
	3 & 4	200	E9000L4G10	E9000L4G4

NOTE: Above harnesses utilize standard GE type THW (flamenol) wire/cable. Do not order above catalog numbers if your motor control center was ordered with special type power wire/cable.

Common Screws

¼ - 20 Thread Rolling screws – pack of 5	204B4139AAG11
10-32 Thread Rolling screws – pack of 5	204B4139AAG15

Plastic Nameplate rivets – pack of 6	204B4139AAG5
--------------------------------------	--------------

Blank Nameplate – Small – 6" Bucket 1" x 3"

Black face	273A7916P3FC
White Face	273A7916P3EC

Blank Nameplate – Large – 12" Bucket & Larger .5" x 2.3"

Black face	273A7916P3F3.5/2.3
White Face	273A7916P3E3.5/2.3

Joint Compound

4oz. Tube	302A3747P3
-----------	------------

Bucket Removal Tool	270A1581G1
---------------------	------------

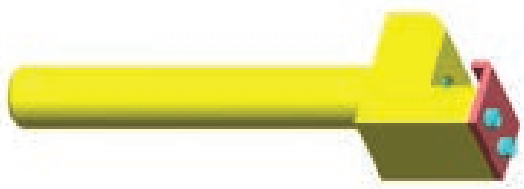

Torque Table Values

Bolt Size	Copper Joint		Aluminum Joint	
	lb-ft	N-m	lb-ft	N-m
5/16 - 18	5 - 9	7 - 12	6.5 - 9	9 - 12
3/8 - 16	12 - 16	16 - 22	10 - 15	14 - 20
1/2 - 13	30 - 39	41 - 53	25 - 35	34 - 47
5/8 - 11	65 - 80	88 - 108	35 - 45	47 - 61
3/4 - 10	125 - 150	169 - 203	50 - 75	68 - 102

Note: When assembling or connecting aluminum bus, apply a suitable joint compound between the contacting surfaces.

GE
Industrial Solutions
41 Woodford Avenue
Plainville, CT 06062
www.geindustrial.com

*Trademark of the General Electric Company and/or its subsidiaries.
Information provided is subject to change without notice. Please verify all details with GE. All values are design or typical values when measured under laboratory conditions, and GE makes no warranty or guarantee, express or implied, that such performance will be obtained under end-use conditions.

4.15 DEG-001